

CITY OF FULLERTON CALIFORNIA CONSTRUCTION PLANS FOR ORANGETHORPE AVENUE INFRASTRUCTURE IMPROVEMENTS FY 2023-24

STATE COLLEGE BLVD. TO PLACENTIA AVE. CITY PROJECT NO. 44062

SHEET INDEX		
SHEET NO.	SHEET DESC.	FILE NO.
1	TITLE SHEET	7082
2	STREET CROSS SECTION AND DETAILS	7082
3-4	CONSTRUCTION DETAILS	7082
5-11	WATER IMPROVEMENT PLAN	WD-1869
12-16	STREET IMPROVEMENT PLAN-ORANGETHORPE AVENUE	7082
17	STREET IMPROVEMENT PLAN-PLACENTIA AVENUE	7082
18-21	STRIPING PLAN	MISC 5381

NOTICE TO CONTRACTORS

- CONSTRUCTION SHALL BE PERFORMED IN ACCORDANCE WITH THE STANDARD SPECIFICATIONS FOR PUBLIC WORKS CONSTRUCTION, 2018 EDITION AND THE APPLICABLE REQUIREMENTS OF THE STATE OF CALIFORNIA DEPARTMENT OF TRANSPORTATION STANDARD SPECIFICATIONS, LATEST EDITION, CITY OF FULLERTON STANDARD DRAWINGS AND THE SPECIAL PROVISIONS.
- INSPECTION BY THE CITY SHALL NOT IN ANY WAY RELIEVE THE CONTRACTOR OF THEIR OBLIGATION TO PERFORM THE WORK IN COMPLIANCE WITH THE PLANS AND SPECIFICATIONS.
- THE CONTRACTOR SHALL PROVIDE AND MAINTAIN TRAFFIC CONTROL DEVICES AT ALL TIMES IN ACCORDANCE WITH W.A.T.C.H. MANUAL (LATEST EDITION), CITY APPROVED TRAFFIC CONTROL PLANS, CITY REQUIREMENTS, PROJECT SPECIFICATIONS AND AS DIRECTED BY THE ENGINEER. ARROW BOARDS ARE REQUIRED ON ARTERIAL ROADWAYS. IT IS THE CONTRACTOR'S RESPONSIBILITY TO OBTAIN APPROVAL OF TRAFFIC CONTROL PRIOR TO STARTING WORK.
- THE CONTRACTOR SHALL NOTIFY UNDERGROUND SERVICE ALERT (USA) AT 811 TWO WORKING DAYS PRIOR TO ANY EXCAVATION WORK.
- EXISTING UTILITIES SHOWN ARE BASED ON AVAILABLE RECORDS OF PARENT UTILITY COMPANIES AND MAY NOT ACCURATELY REPRESENT THEIR ACTUAL LOCATIONS. PRIOR TO BEGINNING ANY CONSTRUCTION, THE CONTRACTOR SHALL VERIFY THE ACTUAL LOCATIONS (VERTICAL AND HORIZONTAL) OF ALL UTILITIES. IN THE FIELD OR COORDINATE SUCH INDEPENDENT VERIFICATION WITH THE PARENT UTILITY COMPANIES AND PROVIDE THE CITY WITH THE POTHOLE INFORMATION. THE CONTRACTOR SHALL PROTECT IN PLACE OR COORDINATE WITH PARENT COMPANY FOR THE RELOCATION OF CONFLICTING UTILITIES ENCOUNTERED DURING CONSTRUCTION
- THE ENGINEER DOES NOT WARRANT THE ACCURACY OF SCALED DIMENSIONS ON ANY PLAN. ALL DIMENSIONS SHALL BE AS DESIGNATED ON THE PLANS. THE CONTRACTOR SHALL VERIFY ALL DIMENSIONS AND CONDITIONS BEFORE STARTING WORK.
- CONTRACTOR SHALL VERIFY ALL JOIN CONDITIONS PRIOR TO STARTING WORK. THE CITY SHALL BE NOTIFIED OF ANY DISCREPANCIES PRIOR TO STARTING WORK.
- THE CONTRACTOR SHALL NOT WILLFULLY PROCEED WITH WORK AS DESIGNED WHEN IT IS OBVIOUS THAT UNKNOWN AND/OR GRADE DIFFERENCES EXIST THAT MAY NOT HAVE BEEN KNOWN DURING DESIGN. SUCH CONDITIONS SHALL BE IMMEDIATELY BROUGHT TO THE ATTENTION OF THE CITY.
- THE CONTRACTOR SHALL PROTECT ALL PUBLIC AND PRIVATE PROPERTY AND FACILITIES NOT DESIGNATED TO BE REMOVED OR MODIFIED ON THE PLANS. THE CONTRACTOR SHALL BEAR FULL RESPONSIBILITY AND TOTAL EXPENSE FOR REPAIR/REPLACEMENT OF DAMAGED PROPERTY.
- THE CONTRACTOR IS RESPONSIBLE TO PROVIDE EVIDENCE (PHOTOS/VIDEO) OF EXISTING CONDITIONS PRIOR TO START OF THE PROJECT TO THE CITY.
- CONTRACTOR SHALL NOT BLOCK DRIVEWAYS OR VEHICULAR TRAFFIC DURING PROCESS OF CONSTRUCTION UNLESS PRIOR APPROVAL IS GRANTED BY CITY.
- ALL UTILITY ACCESS COVERS (WATER VALVES, MANHOLES, CLEANOUTS, ETC.) SHALL REMAIN ACCESSIBLE AND FREE OF DEBRIS THROUGHOUT ALL PHASES OF THE PROJECT AND SHALL BE ADJUSTED TO GRADE WITHIN TEN (10) CALENDAR DAYS AFTER COMPLETION OF PAVING. FAILURE TO FOLLOW REQUIREMENTS IS SUBJECT TO A \$250 FINE PER CALENDAR DAY.
- CONTRACTOR SHALL VERIFY LIMITS OF CURB & GUTTER AND SIDEWALK RECONSTRUCTION WITH THE CITY.
- ALL A.C. PAVEMENT AND CONCRETE IMPROVEMENTS TO BE JOINED SHALL BE SAWCUT. CONCRETE SHALL BE SAWCUT AT NEAREST JOINT AS DIRECTED BY CITY INSPECTOR.
- STOCKPILING OF MATERIAL IS NOT ALLOWED WITHIN STREET RIGHT OF WAY.
- CONTRACTOR IS RESPONSIBLE FOR ALL EROSION CONTROL DURING CONSTRUCTION AND MAINTENANCE PERIOD.
- CONTRACTOR IS RESPONSIBLE TO REMOVE ALL SURVEY AND DIG ALERT MARKINGS WITHIN FIVE (5) CALENDAR DAYS AFTER THE CONCLUSION OF THE WORK AS DIRECTED BY THE CITY. FAILURE TO FOLLOW REQUIREMENTS IS SUBJECT TO A \$250 FINE PER CALENDAR DAY.
- CONTRACTOR IS REQUIRED TO MAINTAIN ACCESS FOR TRASH SERVICE. IF CONSTRUCTION WILL IMPACT TRASH SERVICE, THE CONTRACTOR WILL COORDINATE WITH REPUBLIC SERVICES AT LEAST TWO WORKING DAYS PRIOR TO SCHEDULED SERVICE TO PROVIDE FOR TRASH SERVICE. IF NOT COORDINATED, THE CONTRACTOR WILL BE RESPONSIBLE TO PROVIDE TRASH SERVICE.
- REMOVAL/REPAIR/MODIFICATION OF PUBLIC SIDEWALK & DRIVEWAYS SHALL ONLY BE CONSTRUCTED ON ONE SIDE OF THE STREET AT A TIME. CONTRACTOR SHALL NOT IMPACT OR CLOSE PUBLIC SIDEWALK ACCESS ON BOTH SIDES OF THE STREET AT THE SAME TIME. FAILURE TO FOLLOW REQUIREMENTS IS SUBJECT TO A \$250 FINE PER CALENDAR DAY.
- CONCRETE IMPROVEMENTS (REMOVAL, GRADING, FORMS & CONSTRUCTION) MUST BE COMPLETED WITHIN THREE (3) CONSECUTIVE WORKING DAYS. CONCRETE IMPROVEMENTS SHALL NOT BE LEFT IN PROGRESS/OPEN OVER A WEEKEND. FAILURE TO FOLLOW REQUIREMENTS IS SUBJECT TO A \$250 FINE PER CALENDAR DAY.
- CONTRACTOR AND ALL SUBCONTRACTORS ARE REQUIRED TO MAINTAIN A CURRENT CITY OF FULLERTON BUSINESS LICENSE THROUGHOUT THE DURATION OF THE PROJECT. FAILURE TO FOLLOW REQUIREMENTS IS SUBJECT TO A \$250 FINE PER CALENDAR DAY AND/OR SUSPENSION OF CITY INSPECTION.

ABBREVIATIONS

AP = ANGLE POINT	FS = FINISHED SURFACE
BC = BEGIN CURVE	MH = MANHOLE
BCR = BEGIN CURB RETURN	INV = INVERT
CF = CURB FACE	LIP = LIP OF GUTTER
CL = CENTERLINE	Lt = LEFT
EC = END CURVE	PL = PROPERTY LINE
ECR = END CURB RETURN	Rt = RIGHT
EG = EXISTING GROUND/EDGE OF GUTTER	STA = STATION
EX = EXISTING	SW = SIDEWALK
FL = FLOWLINE	TC = TOP OF CURB
FO = FIBER OPTIC	

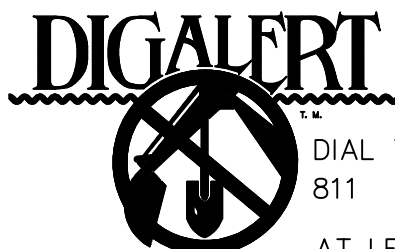

DIAL TOLL FREE
811

AT LEAST TWO DAYS
BEFORE YOU DIG

UNDERGROUND SERVICE ALERT OF SOUTHERN CALIFORNIA

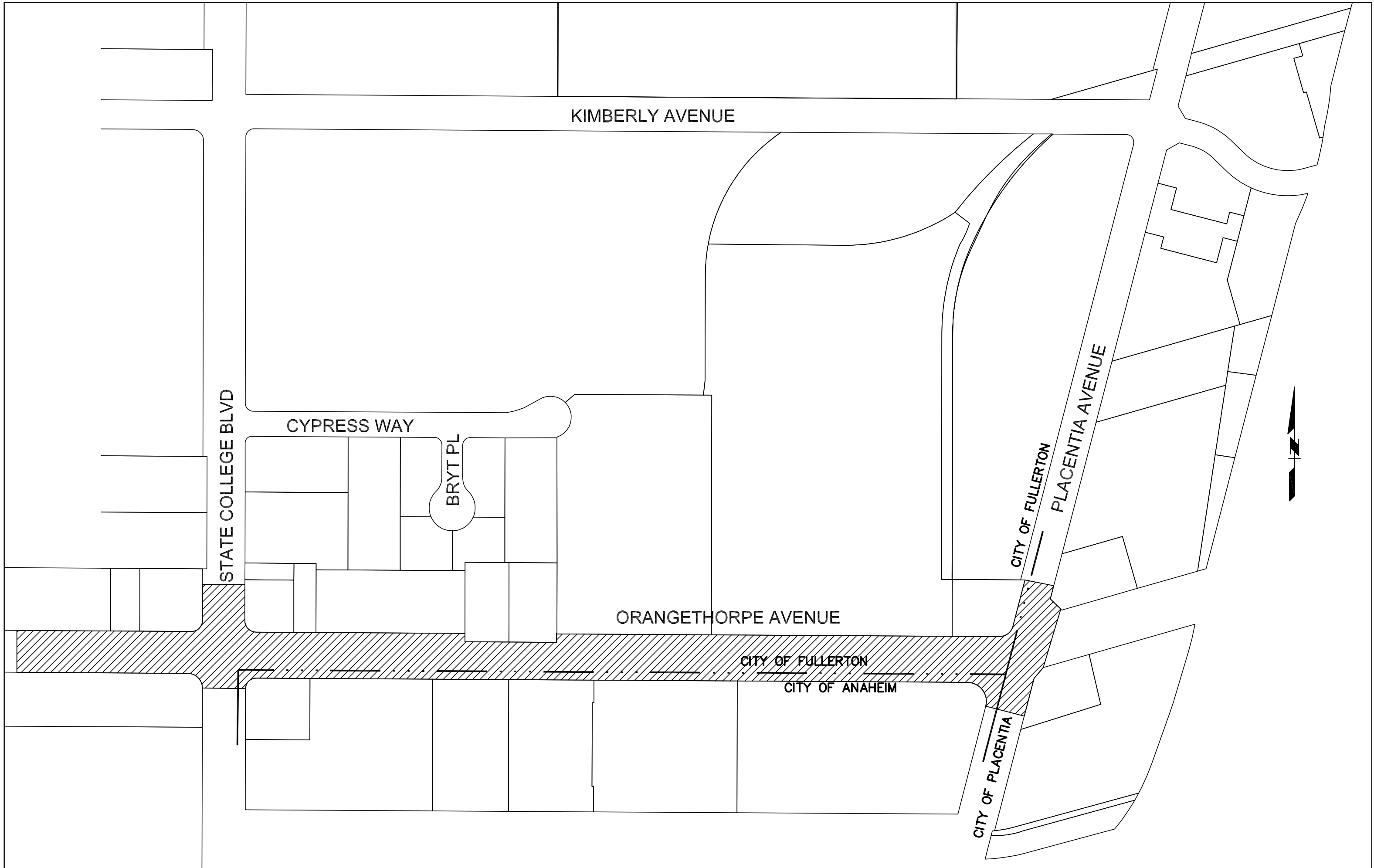

LOCATION MAP

SCALE: 1" = 150'

APPROVALS		APPROVALS RCP2024-21676	
PLACENTIA CITY ENGINEER	DATE	ANAHEIM CITY ENGINEER	DATE

THESE PLANS WERE PREPARED UNDER THE SUPERVISION OF:



SIGNATURE

DATE

UTILITIES LEGEND

— CATV —	EXISTING CABLE TV FACILITIES
— E (OH) —	EXISTING ELECTRICAL OVERHEAD
— E —	EXISTING ELECTRICAL FACILITIES
— FO —	EXISTING FIBER OPTIC FACILITIES
— G —	EXISTING GAS PIPE (SIZE PER PLAN)
— S —	EXISTING SEWER PIPE (SIZE PER PLAN)
— STL —	EXISTING STREET LIGHT CONDUIT
— SD —	EXISTING STORM DRAIN PIPE (SIZE PER PLAN)
— TS —	EXISTING TRAFFIC SIGNAL CONDUIT
— T —	EXISTING TELEPHONE FACILITIES
— W —	EXISTING WATER PIPE (SIZE PER PLAN)

PROJECT CONTACTS (FULLERTON)

COMPANY	CONTACT	TELEPHONE NO.
CITY OF FULLERTON WATER	RICHARD ARMENDARIZ	(714) 738-5337
CITY OF FULLERTON ELECTRICAL	DANA HUFFMAN	(714) 738-6371
CITY OF FULLERTON SEWER / FACILITY	ANTHONY REYNOSO	(714) 738-2802
CITY OF FULLERTON TRAFFIC	JEFFREY CHINCHILLA	(714) 738-6899
CITY OF FULLERTON AIRPORT	BRENDAN O'REILLY	(714) 738-6323
CHARTER/SPECTRUM	ERNEST CHANG	(562) 383-9989
AT&T DISTRIBUTION	RENEE BERGERON	(714) 618-9115
SOUTHERN CALIFORNIA GAS COMPANY	FERNANDO ROJO	(213) 231-8055
SOUTHERN CALIFORNIA EDISON COMPANY	JASON VEJAR	(562) 533-5060
FIBER OPTIC FACILITIES SIFI NETWORKS	JORDAN HARRIS	(310) 895-8809
ORANGE COUNTY SANITATION DISTRICT	ADRIAN SIEW	(714) 593-7164
M.W.D. SYSTEM PROTECTION OFFICE		(714) 577-5084

PROJECT CONTACTS (ANAHEIM)

COMPANY	CONTACT	TELEPHONE NO.
CITY OF ANAHEIM WATER	STEWART NOBLE	(714) 765-4591
CITY OF ANAHEIM ELECTRICAL	JEFF ROBINSON	(714) 765-6873
CITY OF ANAHEIM CONSTRUCTION SERVICES	JOSE CORTEZ	(714) 765-5039
CITY OF ANAHEIM CONSTRUCTION INSPECTION SERVICES	SCOTT YANAGIHARA	(714) 765-5176 EXT 5059

CITY OF FULLERTON PUBLIC WORKS DEPARTMENT

ACCEPTED:	PUBLIC WORKS DIRECTOR	DATE:
APPROVED:	CITY ENGINEER/ASSISTANT PUBLIC WORKS DIRECTOR	DATE:
SHEET 1 OF 21 SHEETS		FILE: 7082