

CORNER RECORD

BK 71 PG 78

APN No. _____ (Optional) Document Number CR 7409
 City of OAKLAND County of ALAMEDA, California
 Brief Legal Description City of Oakland Street Monument

<div style="border: 1px solid black; width: 100px; height: 100px; display: flex; flex-direction: column; align-items: center;"> <div style="border: 1px solid black; width: 50px; height: 50px; margin-bottom: 5px;"></div> <div style="border: 1px solid black; width: 50px; height: 50px;"></div> </div>	CORNER TYPE		COORDINATES ** (Optional)	
	Government Corner <input type="checkbox"/>	Control <input type="checkbox"/>	N. _____	
	Meander <input type="checkbox"/>	Property <input type="checkbox"/>	E. _____	
	Rancho <input type="checkbox"/>	Other <input checked="" type="checkbox"/>	Zone <u> </u> NAD27 <input type="checkbox"/> NAD83 <input type="checkbox"/>	
	Date of Survey <u>2/26/2015</u>		NAD 83 Epoch _____	
		Elev. _____		

Corner - Left as found ☐ Found and tagged ☐ Established ☐ Reestablished ☐ Rebuilt ☐

In compliance with Section 8771 of the Professional Land Surveyors' Act, this corner record is being filed to ESTABLISH _____ / REESTABLISH _____ the position of an existing monument PRIOR X / SUBSEQUENT _____ to street or highway reconstruction.

Identification and type of corner found: Evidence used to identify or procedure used to establish or reestablish the corner:
In compliance with Section 8771 of the Professional Land Surveyors' Act, this corner record is being filed to establish the position of an existing monument prior to street or highway construction. See page 2 for original location.

A description of the physical condition of the monument as found and as set or reset: _____
Searched for monument, not found. See page 2 for original location.

SURVEYOR'S STATEMENT

This Corner Record was prepared by me or under my direction in conformance with the Land Surveyors' Act on May 19 20 15.
 Signed Randell Scott West L.S. or R.C.E. Number 8663

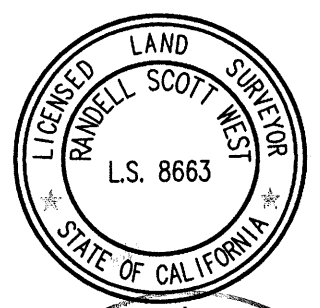

COUNTY SURVEYOR'S STATEMENT

This Corner Record was received 6-25 20 15 and examined and filed 9-4 20 15.
 Signed [Signature] Title County Surveyor

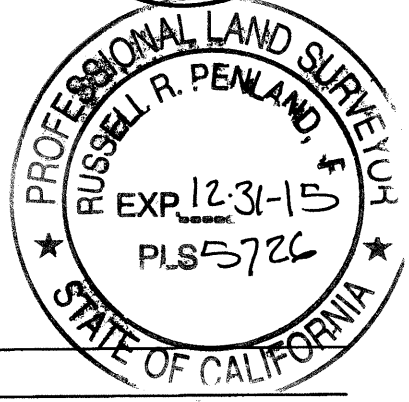

County Surveyor's Comment _____

COORDINATES ** Coordinates are Navigational quality only, not for retracement.

Job Number: _____ Spec. No: _____

